





Use this information to answer Question 1.

Tablet Computer A		Tablet Computer B	
			
Processor	1.5 GHz	Processor	1.7 GHz
RAM	2 GB	RAM	3 GB
Battery life	8 hours	Battery life	6 hours
Weight	28 g	Weight	32 g
Camera	6 MP	Camera	8 MP
Connectivity	USB 2.0	Connectivity	Wi-Fi
Microphone	Mono	Microphone	Mono
Tablet Computer C		Tablet Computer D	
			
Processor	2 GHz	Processor	2.3 GHz
RAM	4 GB	RAM	3 GB
Battery life	5.5 hours	Battery life	9 hours
Weight	35 g	Weight	24 g
Camera	6 MP	Camera	5 MP
Connectivity	3G	Connectivity	USB 3.0
Microphone	Stereo	Microphone	Mono

1 (a) Romana would like to purchase a tablet.

(i) Which **one** of these has the most memory? (1)

☐ Tablet Computer A

☐ Tablet Computer B

☐ Tablet Computer C

☐ Tablet Computer D

(ii) Which **one** of these has the camera with the highest resolution? (1)

☐ Tablet Computer A

☐ Tablet Computer B

☐ Tablet Computer C

☐ Tablet Computer D

(iii) Which **one** of these has the best microphone? (1)

☐ Tablet Computer A

☐ Tablet Computer B

☐ Tablet Computer C

☐ Tablet Computer D

(iv) Which **one** of these would be suitable for accessing mobile broadband? (1)

☐ Tablet Computer A

☐ Tablet Computer B

☐ Tablet Computer C

☐ Tablet Computer D

- (b) The customer then chooses how they would like to receive their tickets. They click on one of these options:

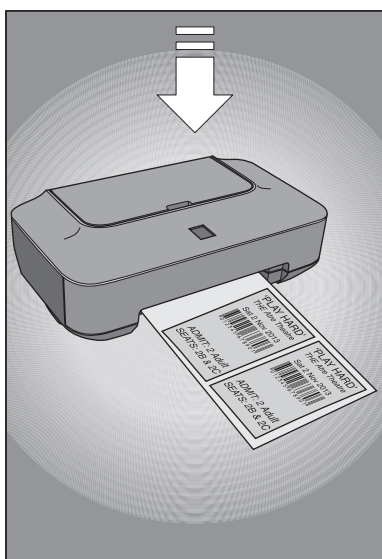

Method A



Method B



Method C

- (i) State how the customer obtains the ticket for each of these methods. (3)

A

.....

B

.....

C

.....

- (ii) State **one** advantage and **one** disadvantage to the customer of using Method B. (2)

Advantage:

.....

Disadvantage:

.....